

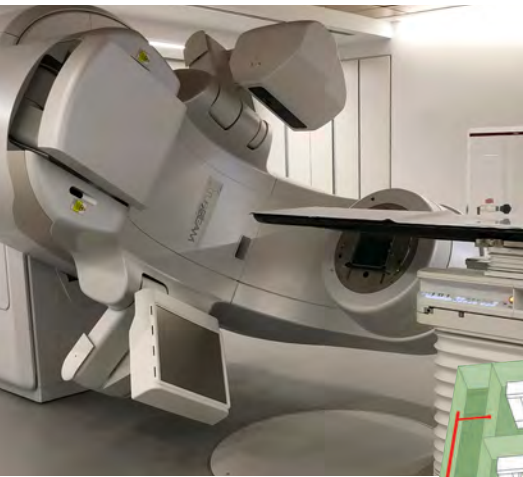

# UPS Systems for Diagnostic Imaging & Radiation Therapy Applications

CPN Power is the market leader in the application of Central UPS for multi-modality and multi-vendor diagnostic imaging and radiation therapy applications. CPN Power pioneered the approach more than 23 years ago.

## ONCOLOGY



## HYBRID OR SUITES



## CARDIOLOGY

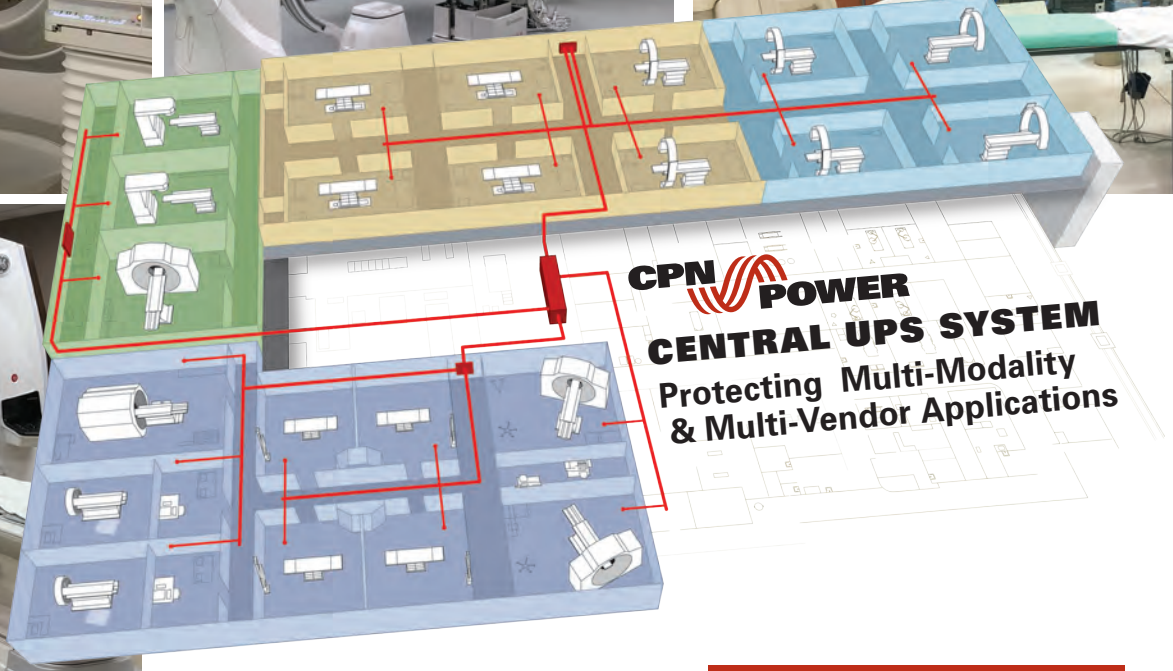
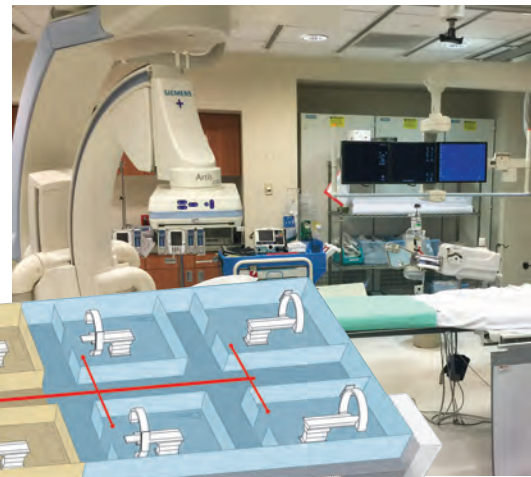

## RADIOLOGY

**4-5 SUITE PROTECTION:** This isometric displays a typical 300 kVA UPS application supporting 4-5 modalities. Protection can be offered for:

- MRI, CT Scanner, Rad, R&F, IR Lab
- 3 Cath Labs, 1 EP Lab, 1 Angio Lab
- 3 LinAcs, 1 CT Simulator, 1 PET/CT

A 500kVA UPS protecting up to 15 Suites is another common application. Larger sizes are available when protecting applications up to 50 suites.

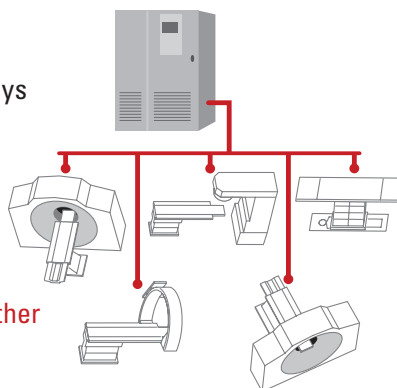

To learn more about Central UPS Power Protection, call us or visit our website.



# UPS Systems for Diagnostic Imaging & Radiation Therapy Applications

Many hospitals follow the common practice of purchasing a separate UPS System from the medical equipment vendor with each new modality. Sometimes this is the appropriate approach. In such instances, CPN Power offers individual UPS Systems per given modality. However, for most applications the better solution is a Central UPS System supporting 2, 5, 10, 15, 22, or more suites.

CPN Power's Central UPS approach has many advantages when compared to numerous individual UPS systems such as:

- Lower Initial UPS Purchase Price
- Reduced Operational Costs
- Lower Long-Term Maintenance Cost
- Less Floor Space Required
- Reduced Battery Replacement Cost
- Fewer Service Calls
- Improved Patient Scheduling
- Increased Revenue

The chart (right) illustrates the dramatic savings a Central UPS System provides. **\$1,250,000** in savings explains why the Central UPS approach is now widely accepted and applied.

## A CENTRAL UPS SYSTEM NETS \$1,250,000 IN SAVINGS OVER 5 YEARS!

500 KVA UPS 5 YEAR COST COMPARISON INDIVIDUAL VS. CENTRAL APPROACH

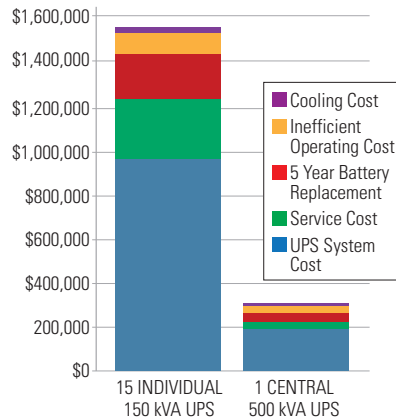

The CPN Power Value Proposition (below) provides an outstanding comparison between the medical equipment vendor individual UPS Solution versus the CPN Power Central UPS approach.

### 3 = 15 VALUE PROPOSITION

#### Medical Equipment Vendor Solution

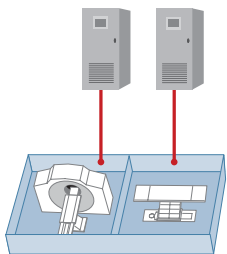

3 UPS Systems  
3 Suites Protected

\$\$\$

#### CPN POWER Solution

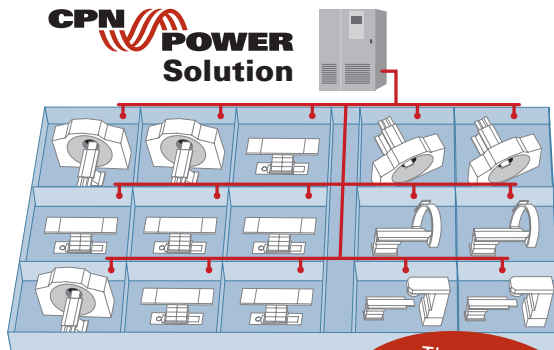

1 Central UPS System  
15 Suites Protected

\$\$\$

The same investment protects 12 Additional Suites!

NOTE: Value propositions are available in many sizing options.

CPN Power has been providing power consulting and solutions for medical equipment applications for 43 years. For the past 23 years, CPN Power has pioneered the application of Central UPS Systems to protect multi-modality and multi-vendor diagnostic imaging and radiation therapy applications.

CPN Power provides UPS Systems and Power Conditioners to support 1-50 Suites including:

Radiology Applications

Cardiology Suites

Oncology Departments

Nuclear Medicine

Hybrid and Standard OR Suites

Outpatient Imaging Centers

Radiation Therapy Centers

Laboratories and PACS

Surgery Centers

Clinical Applications

Critical Branch Protection

Central protection of IDF, MDF, and

Network Closets

CPN Power provides both Static

Double Conversion and Flywheel UPS

Systems



UPS Systems for Diagnostic Imaging & Radiation Treatment Applications

cpnpower.com  
800-491-1210

Over 43 years of Healthcare power expertise, along with the best medical imaging UPS on the market, makes CPN Power the right partner for your medical equipment projects. Call us today to review your application.